

## Priključci za vazduh od nerđajućeg čelika (316 L)

- Priključci od nerđajućeg čelika (316 L) sa zaptivkama od FKM
- Jednostavno spajanje
- Jednostavno rastavljanje
- Visoka sigurnost spoja
- Namenedeni za primenu u prehrambenoj, farmaceutskoj, hemijskoj industriji za rad u agresivnim okruženjima i za rad na povišenim temperaturama
- Pogodni za upotrebu kod različitih tipova pneumatskih creva

### Tehničke karakteristike

- Radni medijum: Vazduh, voda
- Radni pritisak: 0 - 18 bar
- Vakuum max: - 0,99 bar
- Radna temperatura: - 20 ... + 150 °C

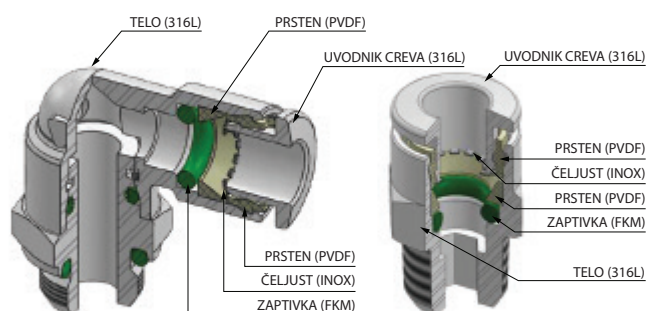

## Priključak ravni tip SUS-PC-R navoj

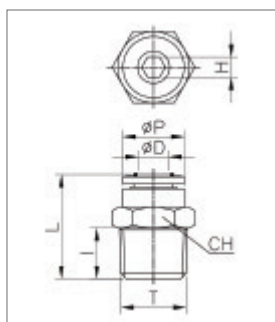

| Model         | Lager | ØD | T     | ØP | I  | L    | CH | H |
|---------------|-------|----|-------|----|----|------|----|---|
| SUS-PC-4-R1/8 |       | 4  | R 1/8 | 10 | 8  | 18,5 | 10 | 3 |
| SUS-PC-4-R1/4 |       | 4  | R 1/4 | 10 | 10 | 20   | 14 | 3 |
| SUS-PC-6-R1/8 |       | 6  | R 1/8 | 12 | 8  | 21   | 12 | 4 |
| SUS-PC-6-R1/4 |       | 6  | R 1/4 | 12 | 10 | 20,5 | 14 | 4 |
| SUS-PC-8-R1/8 |       | 8  | R 1/8 | 14 | 8  | 26   | 14 | 5 |
| SUS-PC-8-R1/4 |       | 8  | R 1/4 | 14 | 10 | 24   | 14 | 6 |

## Priključak ravni tip SUS-PC-G navoj

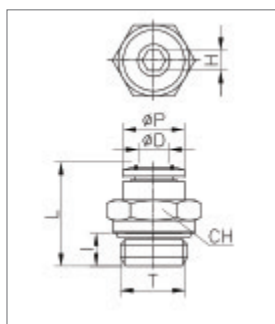

| Model         | Lager | ØD | T      | ØP | I   | L    | CH | H   |
|---------------|-------|----|--------|----|-----|------|----|-----|
| SUS-PC-4-M5   |       | 4  | M5x0.8 | 10 | 4   | 19   | 10 | 2.5 |
| SUS-PC-4-G1/8 |       | 4  | G 1/8  | 10 | 5.5 | 18   | 13 | 3   |
| SUS-PC-6-M5   |       | 6  | M5x0.8 | 12 | 5   | 21   | 12 | 2.5 |
| SUS-PC-6-G1/8 |       | 6  | G 1/8  | 12 | 5.5 | 19.5 | 13 | 4   |
| SUS-PC-6-G1/4 |       | 6  | G 1/4  | 12 | 6.5 | 19.5 | 16 | 4   |
| SUS-PC-8-G1/8 |       | 8  | G 1/8  | 14 | 5.5 | 24.5 | 14 | 5   |
| SUS-PC-8-G1/4 |       | 8  | G 1/4  | 14 | 6.5 | 21.5 | 16 | 6   |

## Priključak ugaoni obrtni tip SUS-PL-R navoj

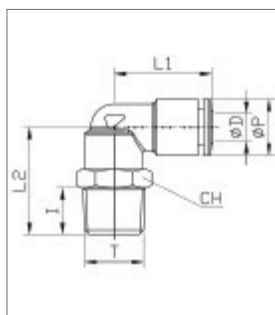

| Model         | Lager | ØD | T     | ØP | I  | L1   | L2   | CH |
|---------------|-------|----|-------|----|----|------|------|----|
| SUS-PL-4-R1/8 |       | 4  | R 1/8 | 10 | 8  | 19,5 | 20,5 | 13 |
| SUS-PL-6-R1/8 |       | 6  | R 1/8 | 12 | 8  | 21   | 20,5 | 13 |
| SUS-PL-6-R1/4 |       | 6  | R 1/4 | 12 | 10 | 21   | 23   | 14 |
| SUS-PL-8-R1/8 |       | 8  | R 1/8 | 14 | 8  | 23   | 20,5 | 14 |
| SUS-PL-8-R1/4 |       | 8  | R 1/4 | 14 | 10 | 23   | 23   | 14 |

## Priključak ugaoni obrtni tip SUS-PL-G navoj

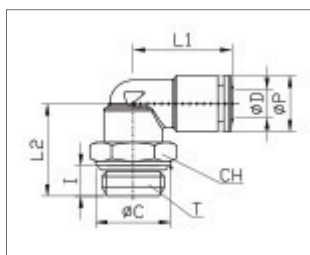

| Model         | Lager | ØD | T      | ØP | ØC | I   | L1   | L2   | CH |
|---------------|-------|----|--------|----|----|-----|------|------|----|
| SUS-PL-4-M5   |       | 4  | M5x0.8 | 10 | 7  | 4   | 18   | 16.5 | 8  |
| SUS-PL-4-G1/8 |       | 4  | G 1/8  | 10 | 13 | 5.5 | 19.5 | 19   | 13 |
| SUS-PL-6-M5   |       | 6  | M5x0.8 | 12 | 7  | 4   | 21   | 16.5 | 8  |
| SUS-PL-6-G1/8 |       | 6  | G 1/8  | 12 | 13 | 5.5 | 21   | 19   | 13 |
| SUS-PL-6-G1/4 |       | 6  | G 1/4  | 12 | 16 | 6.5 | 21   | 21   | 16 |
| SUS-PL-8-G1/8 |       | 8  | G 1/8  | 14 | 13 | 5.5 | 23   | 19   | 13 |
| SUS-PL-8-G1/4 |       | 8  | G 1/4  | 14 | 16 | 6.5 | 23   | 21   | 16 |

## Priključak spojni tip SUS-PUC

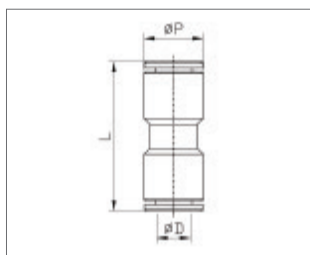

| Model     | Lager | ØD | ØP | L    |
|-----------|-------|----|----|------|
| SUS-PUC-4 |       | 4  | 10 | 29   |
| SUS-PUC-6 |       | 6  | 12 | 32   |
| SUS-PUC-8 |       | 8  | 14 | 35.5 |

## Priključak L spojni tip SUS-PUL

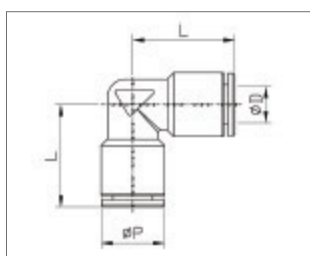

| Model     | Lager | ØD | ØP | L    |
|-----------|-------|----|----|------|
| SUS-PUL-4 |       | 4  | 10 | 16.5 |
| SUS-PUL-6 |       | 6  | 12 | 20.5 |
| SUS-PUL-8 |       | 8  | 14 | 22.5 |

## Račva T tip SUS-PUT

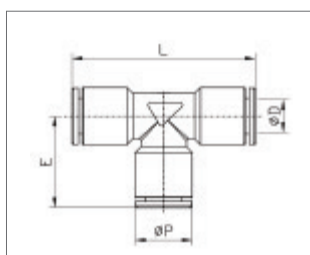

| Model     | Lager | ØD | ØP | E    | L  |
|-----------|-------|----|----|------|----|
| SUS-PUT-4 |       | 4  | 10 | 16.5 | 33 |
| SUS-PUT-6 |       | 6  | 12 | 20.5 | 41 |
| SUS-PUT-8 |       | 8  | 14 | 22.5 | 45 |